

BONEX - HF206

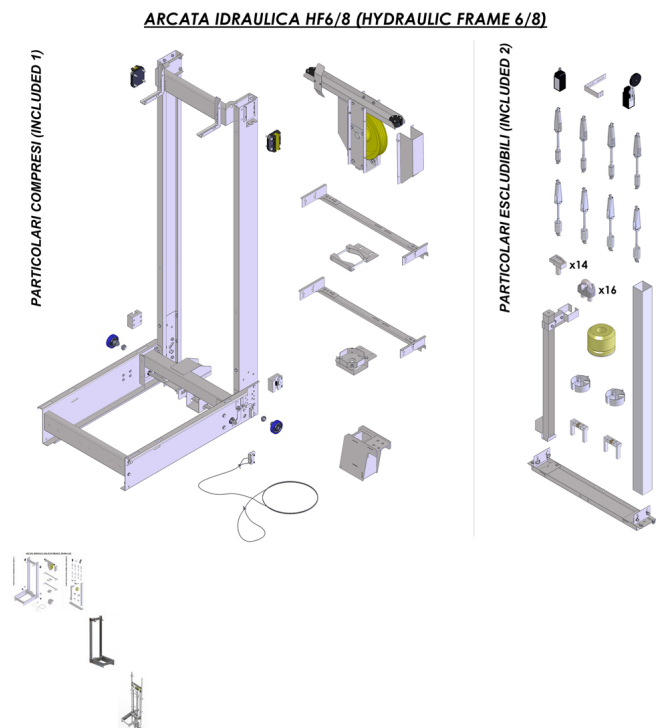

BONEX hydraulic car frame Q=500Kg

Rating: Not Rated Yet

[Ask a question about this product](#)

Manufacturer [Bonex](#)

Description



Hydraulic car frame mod.206 size (2:1) can be used for systems with stroke lengths of 25m, and with rated capacities up to Q=500Kg. Their extreme versatility allows its' use in fields as varied, from small buildings to offices, shops or from use in warehouses until the hospitals, cabins used as transportation of persons or property. the care frame chair allows a wide configuration of access in the cabin: single, double adjacent double opposite, adjacent triple.

Includes 2 diferent DBG (800mm, 900mm) to fit the needs of the customer, comes with various accessories such as safety slackening rope switch, oilers, buffers, shoes, rope clamp and so many other, our standard includes a car frame equipped with all its accessories, for special requests you may ask the exclusion of some components. the quality and reliability of our car frame are guaranteed thanks to the use of modern production systems such as, 3D CAD design software, laser cutting with a high-quality surface finish, treatment of cataphoresis with epoxy resin, which ensures a high resistance to corrosion and to external agents.

Reviews

There are yet no reviews for this product.